

Freedom Express

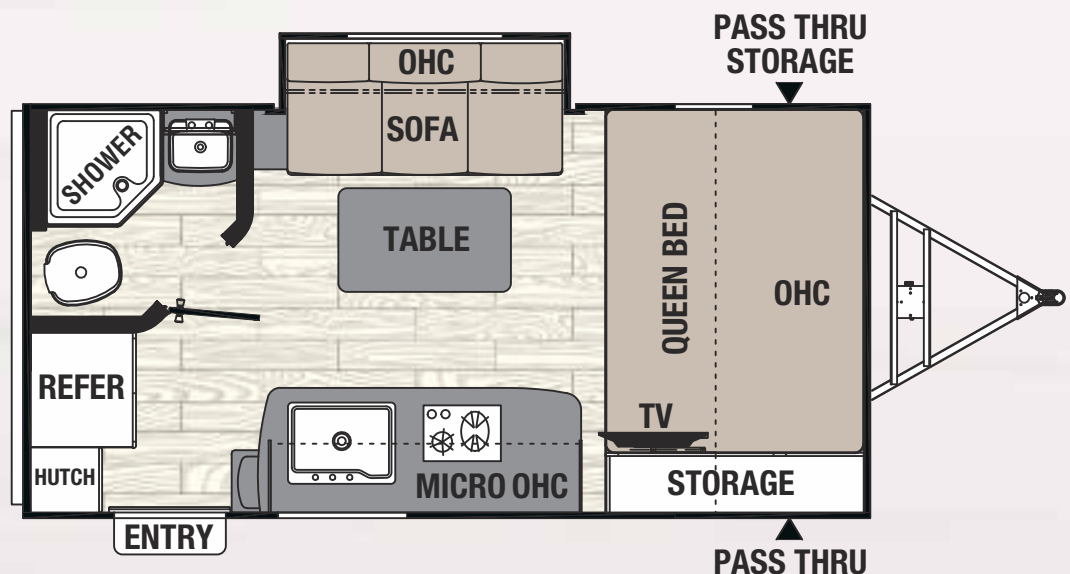

**FREEDOM
EXPRESS
BLAST**

PILOT



19 FBS / Exterior Length 20'

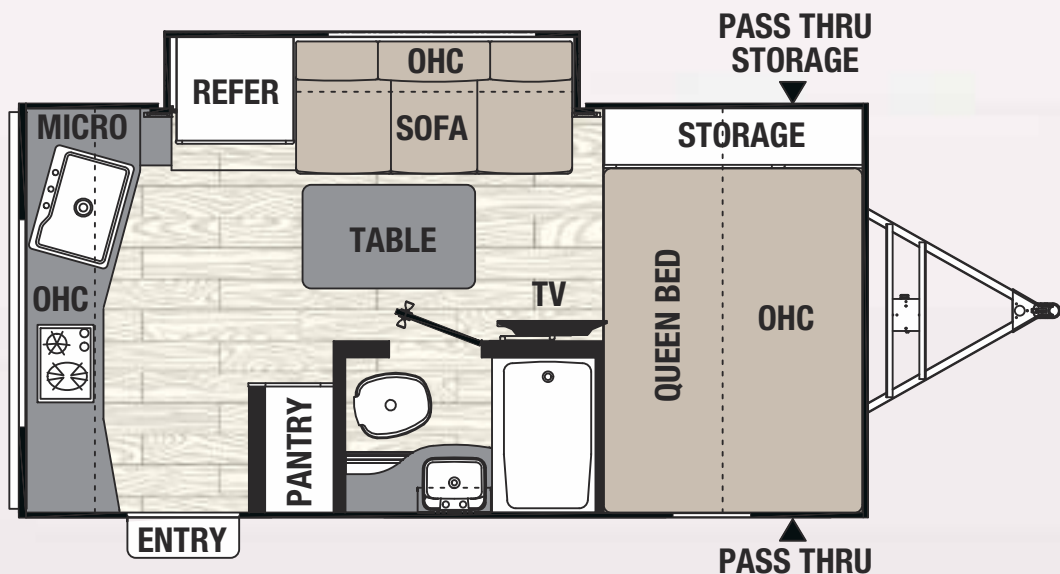

19 RKS / Exterior Length 20'

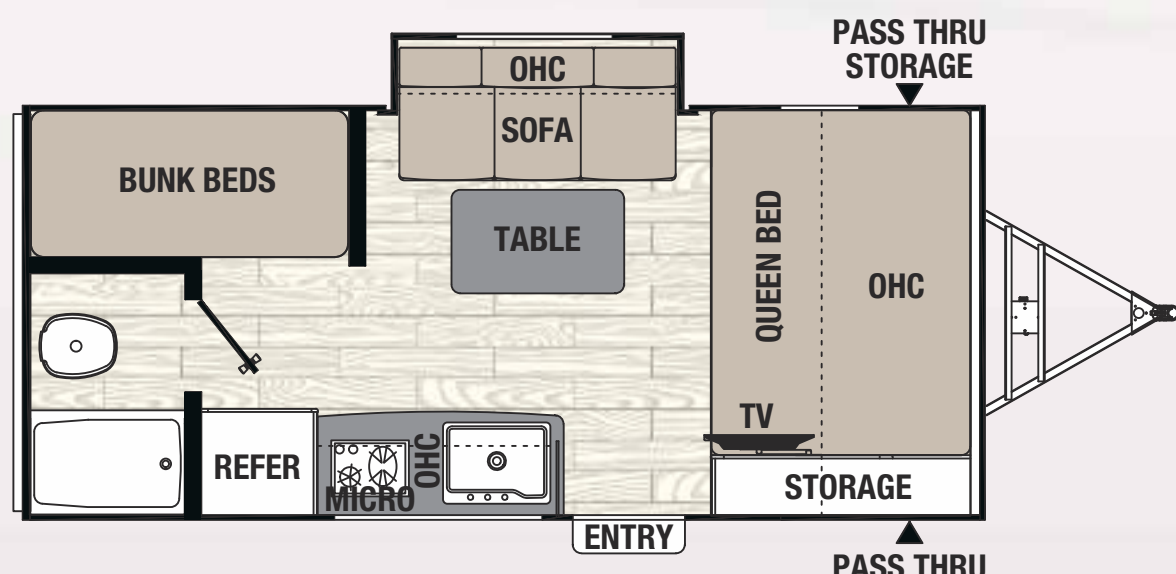

20 BHS / Exterior Length 22'

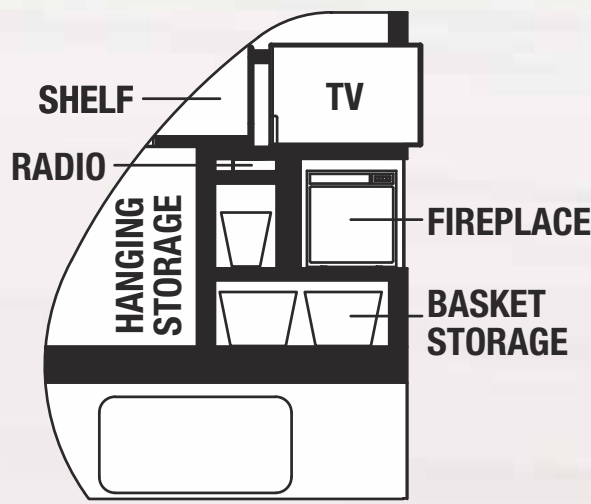

Pilot models include this well-planned storage area

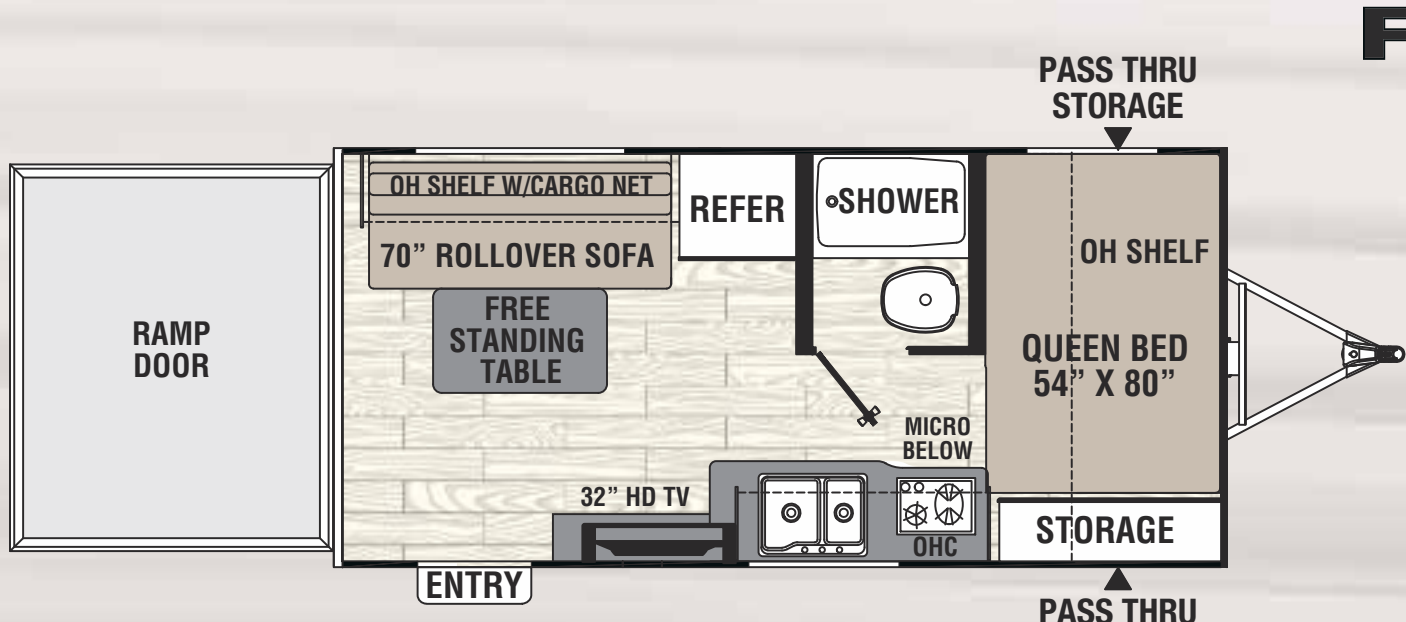

17 BLSE / Exterior Length 20' 4"

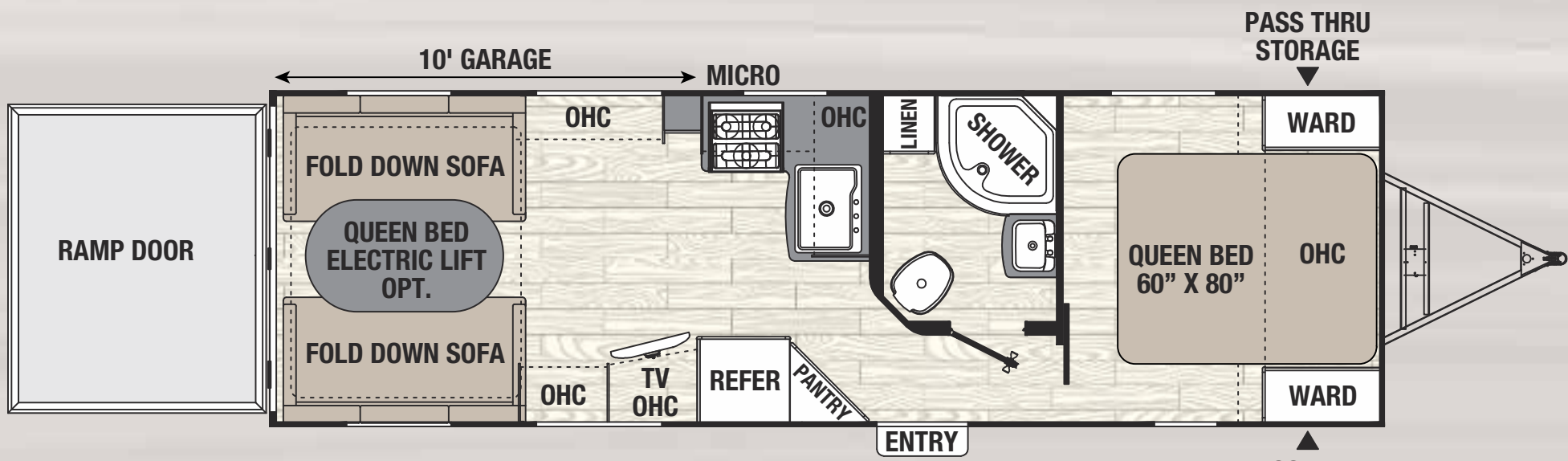

271 BL / Exterior Length 30' 11"

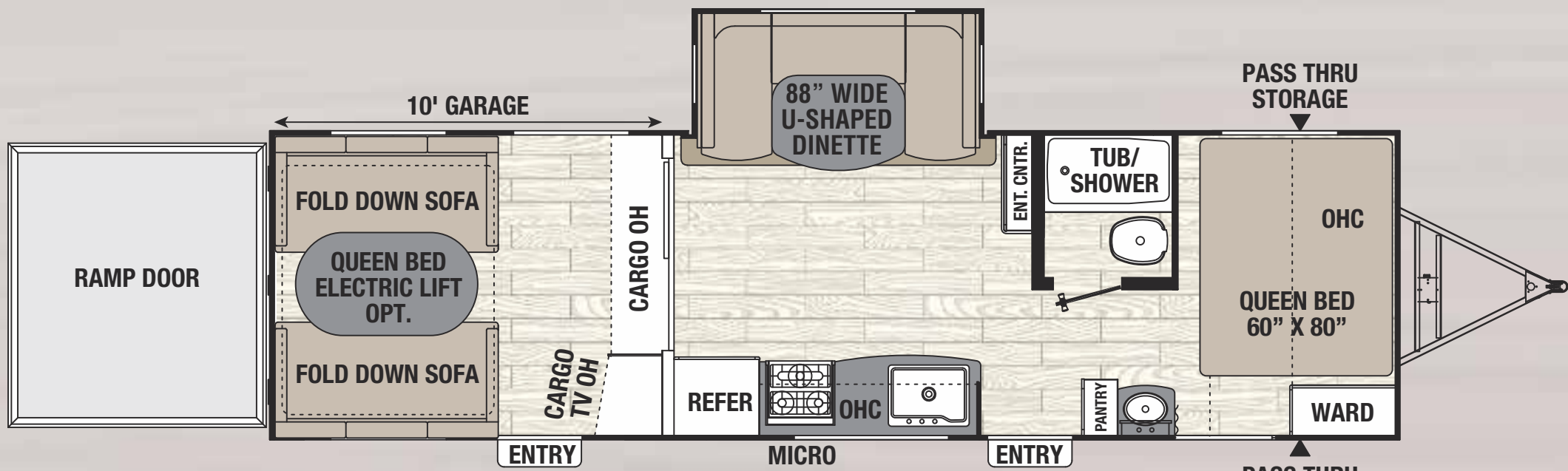

301 BLDS / Exterior Length 33' 7"

Expandables

Under 5,000 lbs. to tow!

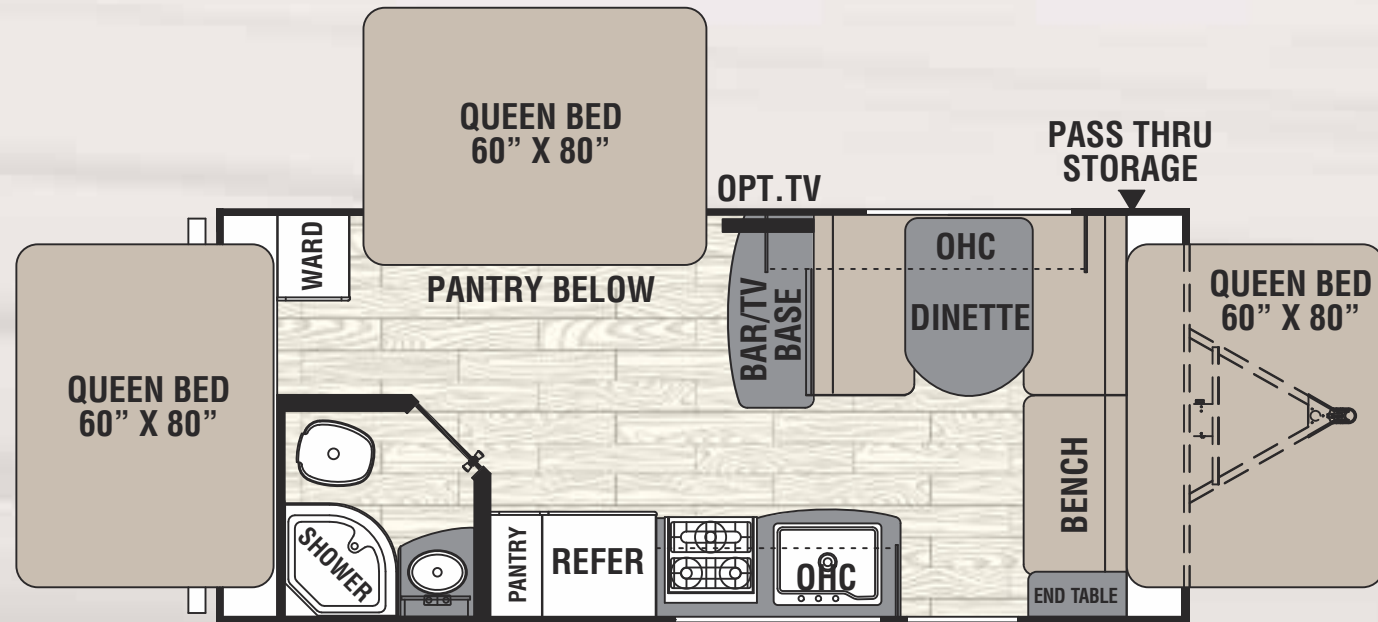

21 TQX / Exterior Length 22' 7"

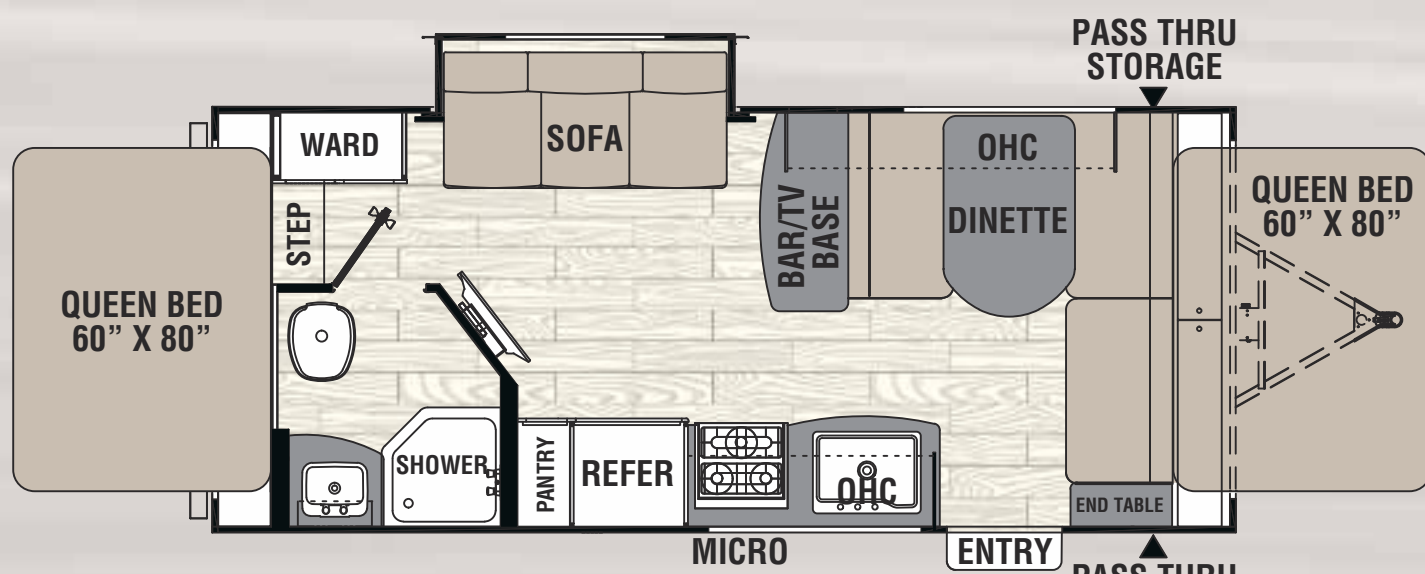

22 TSX / Exterior Length 23' 0"

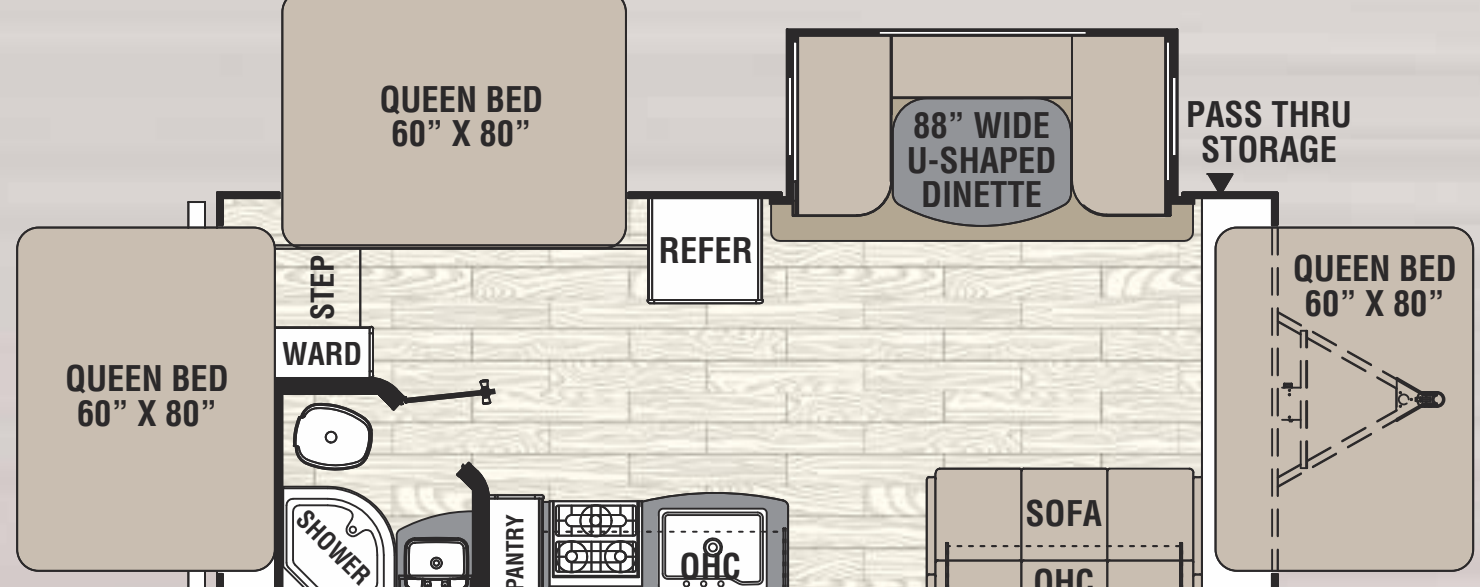

23 TQX / Exterior Length 24' 3"



- 50% Lighter than wood
- No rot, mold or water damage
- R-2 thermal insulation
- Odorless, no formaldehyde
- Sound and energy absorbing
- Impact and puncture resistant
- Made in USA

FREEDOM TO EXPLORE



	PILOT EDITION			BLAST TOY HAULERS				EXPANDABLES		
Freedom Express	19FBS	19RKS	20BHS	17 BLSE	271 BL	301 BLDS	301 BLDSLE	21 TQX	22 TSX	23 TQX
UVW*	3,695	3,820	3,883	3,576	5,806	6,819	6,993	3,650	4,450	4,705
Hitch Weight	406	468	445	426	799	901	953	430	550	635
Carrying Capacity	1,105	980	917	2,324	3,194	3,081	2,907	2,150	2,550	2,295
Exterior Length	20'	20'	22'	20' 4"	30' 11"	33' 7"	33' 7"	22' 7"	23' 0"	24' 3"
Exterior Height	10' 6"	10' 6"	10' 6"	10' 3"	11' 9"	11' 10"	11' 10"	10' 3"	10' 9"	10' 9"
Interior Height	81"	81"	81"	81"	90"	90"	90"	81"	81"	81"
Awning Length	12'	12'	12'	12'	20'	18'	18'	14'	16'	18'
Fresh/Grey/Waste Water Capacity (gal.)	49/33/33	49/33/33	49/33/33	49/33/33	98/33/33	98/33/33	98/33/33	36/30/30	36/30/30	36/30/30
Tire Size	ST225/75R15D	ST225/75R15D	ST225/75R15D	ST205/75R14C	ST225/75R15D	ST225/75R15D	ST225/75R15D	ST205/75R14C	ST205/75R14C	ST205/75R14C

*Unloaded vehicle weights do not include options. See below for definitions of chart descriptions.



Recreational Vehicles

423 N. Main Street • P.O. Box 30 • Middlebury, IN 46540
To learn more about Coachmen RV and our products and see how Coachmen is making the easy life easier, visit www.coachmenrv.com or call 1.800.353.7383.

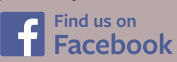

GVWR (Gross Vehicle Weight Rating) is the maximum permissible weight of the unit when fully loaded. It includes all weights, including all fluids, cargo, optional equipment and accessories.
For safety and product performance do not exceed the GVWR.
GVWR (Gross Vehicle Weight Rating) is the maximum permissible weight, including cargo, fluids, optional equipment and accessories that can be safely supported by a combination of all axles.
UVW (Unloaded Vehicle Weight) is the typical weight of the unit as manufactured at the factory. It includes all weight at the unit's axle(s) and tongue or pin and LP Gas. The UVW does not include cargo, fresh potable water, additional optional equipment or dealer installed accessories.
*Estimated Average based on standard build optional equipment.

CCC (Cargo Carrying Capacity) is the amount of weight available for fresh potable water, cargo, additional optional equipment and accessories. CCC is equal to GVWR minus UVW. Available CCC should accommodate fresh potable water (8.3 lbs per gallon). Before filling the fresh water tank, empty the black and grey tanks to provide for more cargo capacity.
*Estimated average based on standard build optional equipment.
Each Forest River RV is weighed at the manufacturing facility prior to shipping. A label identifying the unloaded vehicle weight of the actual unit and the cargo carrying capacity is applied to every Forest River RV prior to leaving our facilities. The load capacity of your unit is designated by weight, not by volume, so you cannot necessarily use all available space when loading your unit.

All information contained in this brochure is believed to be accurate at the time of publication. However, during the model year, it may be necessary to make revisions and Forest River, Inc. reserves the right to make all such changes without notice, including prices, colors, materials, equipment and specifications as well as the addition of new models and the discontinuance of models shown in this brochure. Therefore, please consult with your Forest River dealer and confirm the existence of any materials, design or specifications that are material to your purchase decision. ©2017 Freedom Express by Coachmen, a Division of Forest River, Inc., a Berkshire Hathaway company. All Rights Reserved. 11/17



Learn More
Scan this barcode using a QR Reader on your smart phone to learn more about Forest River.

